

ITEM NO.	DESCRIPTION	LENGTH	MATERIAL	MASS (kg)
1	114x6.0 CHS	4780	316L STAINLESS STEEL	78.06

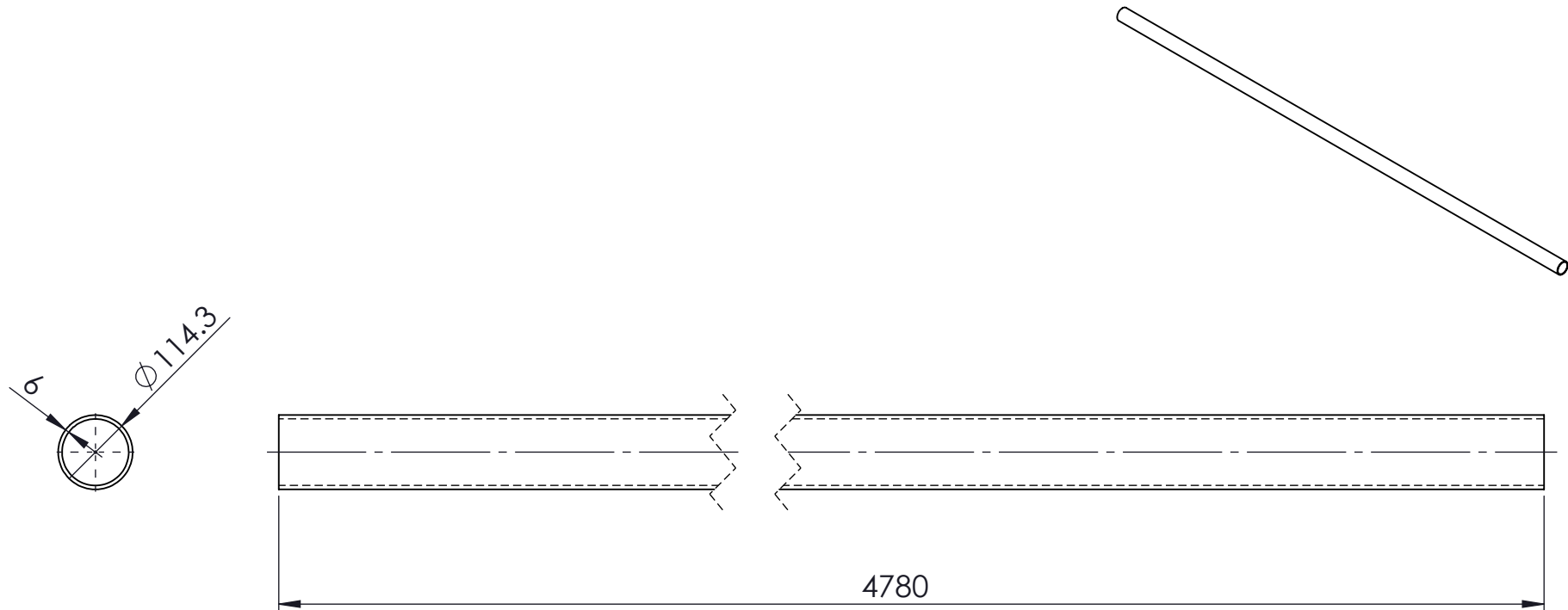

MATERIAL:- 316L STAINLESS STEEL

100NB SHED 40 PIPE 316 S/S WEIGHT - 78.06 kg

UNLESS OTHERWISE SPECIFIED: TOLERANCES: MACHINE + / - 0.25mm FABRICATION + / - 1.0 mm		DIMENSIONS IN MILLIMETRES	CLIENT	TITLE:	
THIS DRAWING IS THE PROPERTY OF MECHANICAL ENGINEERING & CAD SERVICES (MECS) Pty Ltd & MUST NOT BE MANUFACTURED FROM, COPIED OR TRANSMITTED TO A THIRD PARTY WITHOUT THE PRIOR APPROVAL FROM MECHANICAL ENGINEERING & CAD SERVICES (MECS) Pty Ltd	<div>MECS</div> <div>Mechanical Engineering & CAD Services</div> <div>11 Campbell Place WAGGA NSW 2650</div> <div>Ph: - 0409 985 816</div> <div>Email: nick@mecservices.com.au</div>	<div>THIRD ANGLE PROJECTION</div> <div>WEIGHT: 78.06 kg</div>	<div>RODDY</div> <div>ENGINEERING</div> <div>14 Waratah St TUMUT NSW 2720</div> <div>Ph: - 02 6947 4039</div> <div>Email: roddyeng.com.au</div>	100NB SHED 40 PIPE 316 S/S	
				DWG NO.	A4
				DRAWN N DE BRUYN	DATE 19/09/2025 SCALE:1:10 SHEET 1 OF 1